

PLEASE PROVIDE DETAILS OF ALL DPI's DESCRIBED BELOW
 You must state "none" in the relevant box where you or your partner have no interest in a particular category.

| | | |
|--|---|-----------|
| NAME: (Block Capitals) <i>Mrs. Jean Simmons</i> | | |
| COUNCIL: <i>Kingswood Parish Council</i> | | |
| | Your Interests | P. |
| 1. Employment: any employment or office held, or trade, profession or vocation carried on, by you or your partner for profit or gain. | <i>Dairy Farmer. Director of Simmons Farms LTD Jolly Farm Kingswood Wotton-u-edge</i> | |
| 2. Sponsorship: any payment or financial benefit towards your election expenses or expenses as a member received within the last 12 months, excluding any from your council. | <i>NONE</i> | |
| 3. Contracts: any current contract between your council and you, or your partner, or any body in which you or your partner are a partner, director, or shareholder. | <i>NONE</i> | |
| 4. Land: any land which is in your Council's area which you or your partner own, have a right to occupy, or receive the income from (excluding a licence to occupy land for less than a month). | <i>Jolly Farm Kingswood Wotton-u-edge.</i> | |
| 5. Corporate tenancies: any tenancy between your council and a body in which you or your partner are a partner, director, or shareholder. | <i>Director of Simmons Farms LTD</i> | |

| | Your Interests | Partner's Int |
|--|---|---------------|
| <p>6. Securities: any beneficial interest in any shares or other securities of any description in a body held by you or your or your partner if the body has a place of business or land in your council's area, and:</p> <ul style="list-style-type: none"> • the total value of the securities held is over £25,000, or • you or your partner hold more than one hundredth of the total issued share capital of the body, or • if the body has more than one class of shares you or your partner hold more one hundredth of the issued share capital of that class | <p>Dany Yarness Director of Simmons Yarness Lro. Holly Farm Kingswood Wotton-u-edge</p> | |

DECLARATION

I have not omitted information that ought to be given in this notice and have not provided information that is false or misleading.

Signed

Dated 21-4-2021

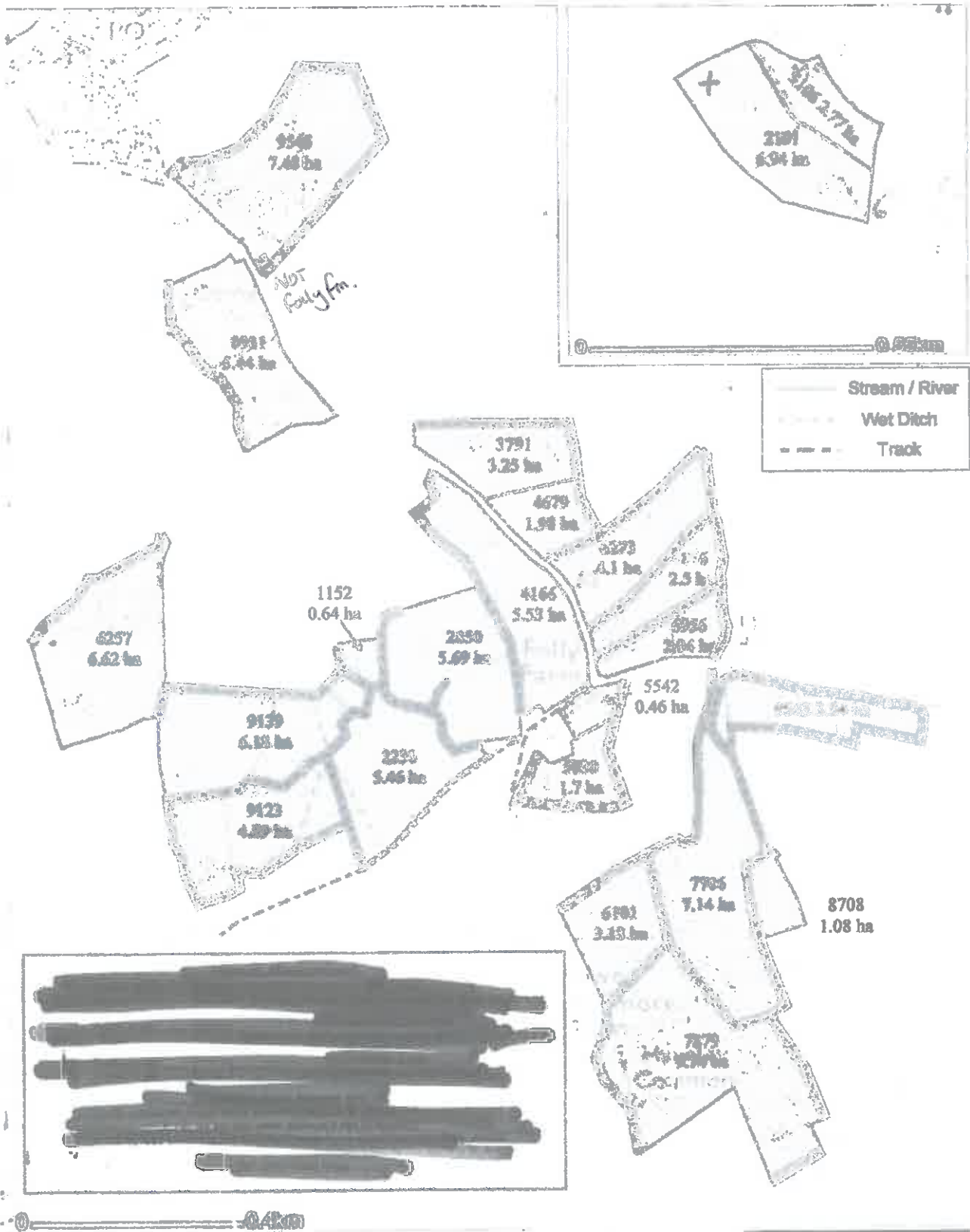

Sample Farmer Simmons Farms.
Sample Farm

12 05 1 05 5 9123 4166 6101 5542 3106 7

